

PRODUCT POSITIONING

The Force strikes the perfect balance between all-day comfort and performance. The durable planet-friendly leather upper features a padded tongue and heel cup to further enhance comfort. A full-length outsole and our V-Tension system provide strong underfoot support to keep you going mile after vertical mile. The Force is perfectly suited for both indoor and outdoor climbing.

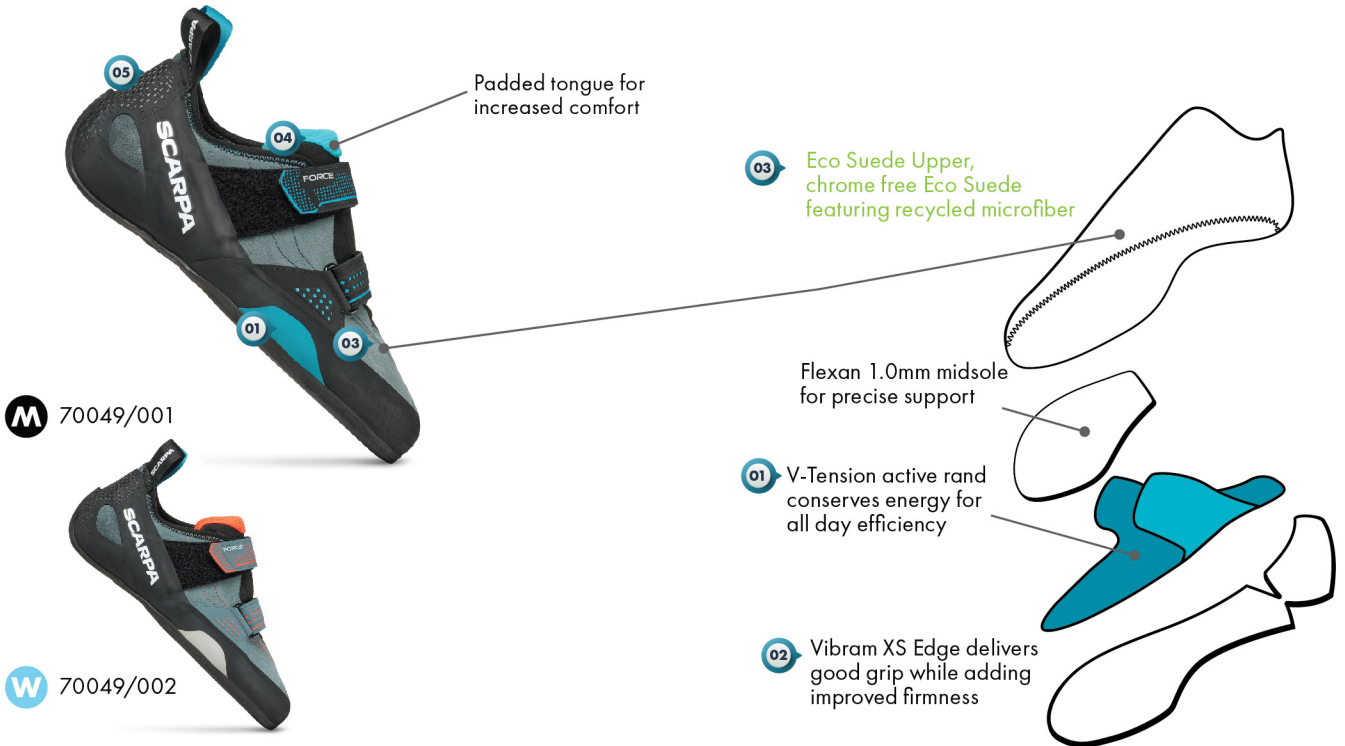

FEATURES AND BENEFITS

- 01** **V-Tension™ active rand** conserves energy for all day efficiency
- 02** **Vibram® XS Edge** provides incredible grip and durability
- 03** **Eco Suede Upper:** Planet friendly, chrome free Eco Suede is both durable and supple. It features a recycled microfiber backing for additional comfort and durability.
- 04** **Padded Tongue:** Increases comfort for the long big mileage days as well as marathon gym sessions.
- 05** **Padded Heel:** Padded cup heel helps mitigate potential hot spots and increases comfort.

SPECIFICATIONS

- Upper: **1.8mm Eco Suede**
- Insole: Flexan 1.0mm Forefoot
- Outsole: Vibram XS® Edge (3.5mm)
- Last: Men's - FFX; Flat, Slightly Asymmetric
Women's FFXW; Flat, Slightly Asymmetric
- Sizes: Men's - 39-47 (½ sizes); 48-50 (whole sizes)
Women's - 35-42 (½ sizes)
- Weight: Men's - 250g; 8.8oz (½ pair, size 40)
Women's - 225g; 7.9oz (½ pair size 38)
- Origin: Italy

TECHNOLOGIES



TECHNOLOGY - MATERIALS - CONSTRUCTION

V-Tension System - V-Tension system enhances toe-pulling power by supporting the arch and forefoot area. This tensioned rubber wrap is paired with a full sole unit and so does not need rear bands. It works in the same way as X-Tension to maintain the optimum foot position for small footholds.



Flexan - Flexan is an Italian made insole board material made primarily of cellulose. Cellulose is the most abundant organic material on the planet, typically derived from cotton or wood pulp. The cellulose fibers are combined with binding agents that yield a durable, yet flexible sheet material that can be sourced in varying thicknesses. It is durable, flexible and easy to work with.

Vibram® XS Edge Rubber - Developed to provide maximum edging support, the VIBRAM® XS Edge delivers good grip while adding improved firmness for the most challenging edging moves.

SCARPA Planet Friendly – Our products tread the most wonderful and unspoiled landscapes on earth. We feel we must do our best to preserve these landscapes. “Planet Friendly”, products made of environment-friendly materials refer to products in which materials and processes are specifically chosen for their environmentally friendly characteristics.

Fit - Men's: FFX Last – Medium width, low angle toe box with medium volume heel.

Women's FFXW Last – Medium width, low angle toe box with medium volume heel.